

GV Adjustable Projector Mount

Parts:

Parts Listing

- 1-1 Ceiling Cup
- 1-2 Ceiling Mounting Plate
- 1-3 Tilt Angle Adjustment Slot

- 2-1 Main Post
- 2-2 Adjustable Post (4 x 25 mm increments)
- 2-3 Main Post - Front Cover Strip
- 2-4 Main Post - Rear Cover Strip
- 2-5 Adjustable Post - Rear Cover Strip
- 2-6 Locking Clip

- 3-1 Pivot Adjuster
- 3-2 Hanging Pin
- 3-3 Horizontal Adjustment

- 4-1 Projector Mount Plate
- 4-2 Vertical Adjustment
- 4-3 Mounting Arms
- 4-4 Jacking Bolt
- 4-5 Slide Clamp

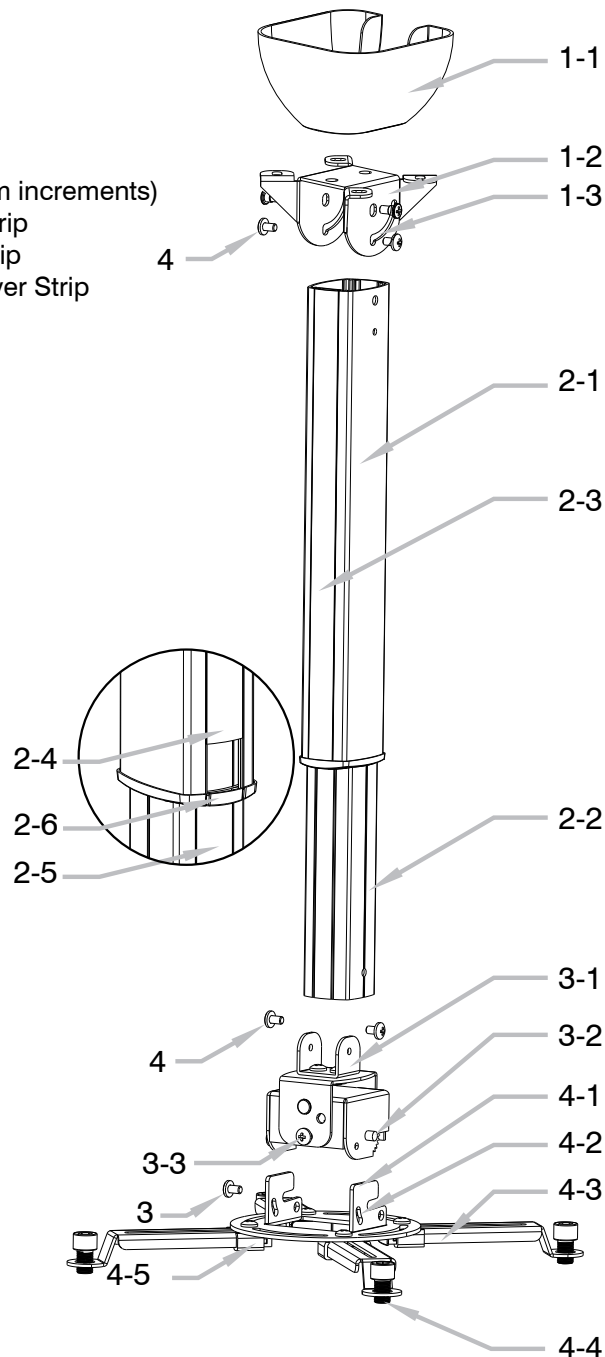

Accessories:

Fixing Mounts

- 1. M6 x 25 Toggle Bolts
- 2. No 6 x 50 Timber Screws.

Assembly Items

- 3. M5 x 8 Phillips Head Screw
- 4. M5 x 10 Phillips Head Screw

Projector Mounting Bolts

- 5. M5 x 30 Phillips Head Screw
- 6. M4 x 30 Phillips Head Screw
- 7. M3 x 30 Phillips Head Screw

GV Adjustable Projector Mount

Instruction Manual:

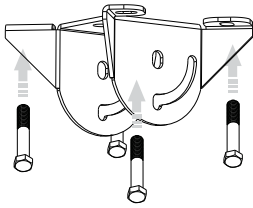

1. Install the Ceiling Mounting Bracket, (figure 1) using the appropriate anchors.

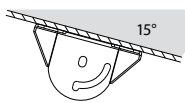

2. Do not exceed the recommended maximum ceiling tilt angle of 15 degrees, (figure 2).

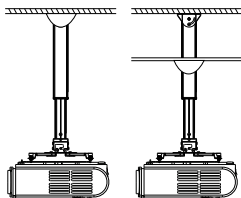

3. The projector mount can also be installed through a false ceiling, (figure 3).

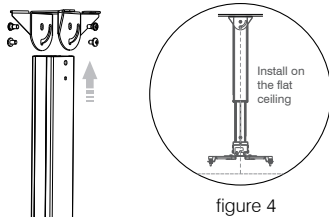

figure 4

- 4 (a) Connect the Main Post to the Ceiling Mounting Plate (Use accessory No 4) feeding the cables through the top of the Main Post and at the top of the Main Rear Cover Strip (2.4).

- 4 (b) Remove the Main Post Front Cover Strip (2.3) to locate the fixing screws and set the Adjustable Post at the required height. Again feed the cables down through the Adjustable Post and release the cables at the base of the Rear Cover Strip (2.5) (see figures 4 & 5).

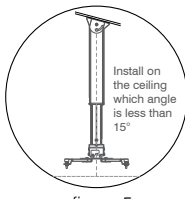
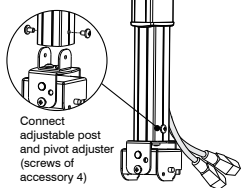

figure 5

- 4 (c) Insert and fix the Pivot Adjuster into the base of the Adjustable Post (use accessory No 4).



Connect adjustable post and pivot adjuster (screws of accessory 4)

5. Mount the Projector to the Projector Mount Plate before attaching to the Pivot Adjuster (use accessory No 3). Fasten all screws before fitting the Ceiling Cup to the ceiling (see figures 6 & 7).

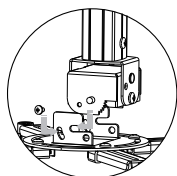

figure 6

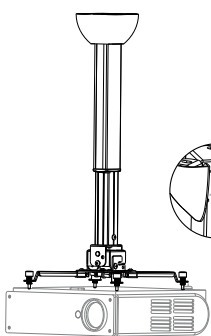

figure 7

gv GRANDVIEW[®]
MEETS YOUR VISION.

www.grandviewscreens.com.au